

## ON-SITE ACTIVITIES & AMENITIES

Card/board/yard games      Basketball goal  
 Cornhole board games      Horseshoe pit  
 Fire pits w/free firewood      Swimming area  
 DIRECTV in lodge      DVDs/CDs  
 Playground w/sand pile      Swings  
 Ice cream & food products for sale      Gift shop  
 Free use of our paddleboat, 2 canoes, and 4 kayaks  
 Free Wi-Fi internet to our 6 cabins

## DOGS

One well-mannered dog is welcome per rental unit and campsite as long as it is pre-approved by us, leashed or kenneled at all times, and cleaned up after immediately. **Linens from your home must be brought to cover and protect our furniture from dog hair if you will be allowing your dog inside our rental units.**

Rental Unit Pet Fee: \$75/week or \$20/day  
 Campsite Pet Fee: \$25/week or \$5/day



On September 20, 2013, we spotted these 2 Moose coming out of the woods into the lake just across from our lodge! We watched them swim across the lake and come ashore just 2 houses to the south of us. What an awesome day that was!

### Rising Eagle Reward!

Stay 2 or more full weeks\* with us during the same calendar year & receive 10% off your basic cabin rate on your 2nd and all subsequent full-week\* stays.

\* A full week is Saturday to Saturday.

## BOAT & MOTOR RENTAL RATES

Rental	Weekly Rate	Daily Rate	Hourly Rate
Resort Boat * ● ∞ (Guest rate)	\$30	\$5	NA
Resort Boat * ● ∞ (Non-guest rate)	\$50	\$15	NA
Extra dock space (Guest rate) * ∞	\$30	\$5	NA
Extra dock space (Non-guest rate) * ∞	\$50	\$15	NA
15 HP Motor * ∞	\$175	\$35	NA
9.9 HP Motor * ∞	\$150	\$30	NA
8 HP Motor * ∞	\$125	\$25	NA
5.5 HP Motor * ∞	\$100	\$20	NA
20-ft. Pontoon * ∞ ±	NA	\$75	\$20

\* Rented on a first-come, first-served basis  
 ● Rental of a resort boat includes a dock space  
 ∞ Gas is not included & must be purchased on-site  
 ± \$100 damage deposit is required prior to rental

## CAMPING

While we are not a licensed campground with the typical electric and water hook-ups, we are able to have up to 4 campsites (tents to RVs) on our property at any given time. Self-contained units are preferable; however, we are able to provide water and electric hookups in certain situations. Camping rates include free firewood, use of bathroom facilities during lodge hours, use of our boat ramp, and use of resort paddleboat, canoe, and kayaks. Dock space is extra if available.

Site	# of People Incl. in Rate	Max. Occ.	Daily Rate	Daily Electric Hookup Fee	Daily Water Hookup Fee
#1	2	6	\$25	\$6	\$6
#2	2	6	\$25	\$6	\$6
#3	2	6	\$25	\$6	\$6
#4	2	6	\$25	\$6	\$6

**Reservations:** First-come, first-served basis  
**Extra Person Rates:** \$3 per person per day  
**Check-In / Check-Out Times:** 3 PM / 9 AM

## VISITORS

If you would like to have visitors during your stay with us, please contact us in advance for details. State law requires all visitors to register upon arrival. Extra person rates may apply.

## SOME ITEMS TO BRING

Linens to cover rental unit furniture if bringing your dog, bath towels/washcloths, camera, binoculars, fishing gear/license, life jackets, extension cords for battery chargers, charcoal & lighter fluid, bug sprays, first aid items

## DIRECTIONS

From Deer River, take Highway 6 North to Highway 4 in Talmoon. Turn west (left) on Highway 4 and follow posted resort road signs to County Road 135 and then turn left. Follow posted signs to Rising Eagle!

**NOTE:** Our location is not correct on some GPS maps, so please be aware of this, especially should you decide to come in the back way via State Hwy. 35 to Co. Rd. 133/Co. Rd. 135.

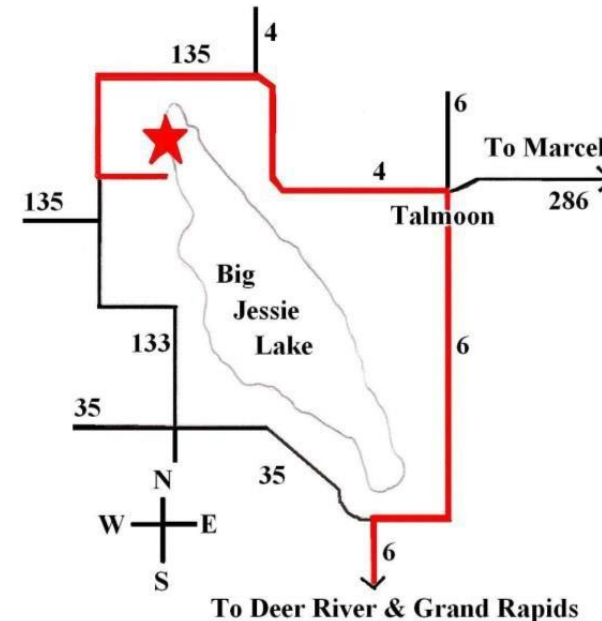

**Call or e-mail us with any questions!**

2017

# Rising Eagle Resort

*Located on Big Jessie Lake  
 in Itasca County, Minnesota  
 in the beautiful  
 Chippewa National Forest!*



**Steve & Patsy Bowers  
 Terry & Angie (Bowers) Dryden**

1 - 800 - 444 - 0098  
 (218) 832 - 3955

[www.risingeagleresort.com](http://www.risingeagleresort.com)  
[getaway@risingeagleresort.com](mailto:getaway@risingeagleresort.com)

47405 County Road 135  
 Talmoon, MN 56637

**WELCOME!**

We are located on the secluded northwest corner of Big Jessie Lake, one of over 1000 lakes located in Itasca County...Minnesota's 3rd largest county. Bald eagles are often seen here as we are in the Chippewa National Forest. Our private setting and Itasca County provide the perfect place to relax, fish, enjoy the wildlife and birds, and to "get away from it all."

Big Jessie Lake is a 1753-acre lake with 9 miles of shoreline (4-1/2 miles long and over 1/2 mile wide). Its maximum depth is 42'. Jessie is actively managed by the MN DNR for walleye and also has great populations of pike, bass, jumbo perch, large crappies & bluegills. The lake welcomes water sport lovers as well!

We look forward to meeting you and helping make your vacation a most enjoyable one!

Your Hosts,  
Steve & Patsy Bowers  
Terry & Angie (Bowers) Dryden

*"But those who wait upon the Lord shall renew their strength; they shall mount up with wings as eagles...." Isaiah 40:31 NKJV*

**OUR RENTAL UNITS**

We have 7 nonsmoking, housekeeping units (6 cabins and our larger family house). Five of our 6 cabins are located within 100 feet of the lake and all 6 of our cabins are without hills or inclines. The family house is located at the resort entrance and thus uphill from the lake and lodge.

Each rental unit comes furnished with:  
 Fridge                      Stove/Oven                      Microwave  
 Toaster                      Coffee pot/filters                      Pots/pans  
 Cook/Bakeware                      Plates/Cups                      Silverware  
 Dish soap                      Dish towels/cloths                      Paper towel  
 Pot holders/oven mitt                      Salt/pepper shakers  
 Bed linens                      Pillows                      1 box fan/bedroom  
 Toilet paper                      Vacuum                      Broom/dust pan  
 Fly swatters                      Picnic table                      Charcoal grill  
**Bath soap and bath towels/cloths are not provided.**



**RENTAL UNIT DESCRIPTIONS**

**Family House:** (1960 sq. ft.) 3 BR, 2 bath home at resort entrance (300' from lodge & 360' from lake). Sleeps 10 with 2 full beds & 4 twins. Queen sleeper & futon in LR. Large open-concept. Washer & dryer. Large gated deck full length of home. Private porch swing & fire pit. Perfect for large groups! Rental includes 2 free dock spaces.

**Cabin #1 – Loon:** (468 sq. ft.) 1 bath, 2 BR cabin that sleeps 6 with 4 twin beds and a queen sleeper in LR. Ramp to large deck with lake view. Cabin does not sit right on the lake, but is approximately 130 feet from the lake. Rental includes 1 free dock space.

**Cabin #2 – Bear:** (588 sq ft.) 1 bath, 3 BR cabin that sleeps 8 with 1 full, 3 twins, 1 bunk, and a day bed in LR. Open concept living/dining room and kitchen areas. This cabin is our closest to the lake at only 58' and thus offers a wonderful lake view from its large deck. Rental includes 1 free dock space.

**Cabin #3 – Wolf:** (468 sq. ft.) 1 bath, 2 BR cabin that sleeps 6 with 5 twin beds and a twin sleeper in LR. Enclosed porch. This cabin was remodeled in 2011 with knotty pine interior and addition of a loft. Has a ramp leading up to the deck and enclosed porch. Rental includes 1 free dock space.

**Cabin #4 – Eagle:** (468 sq. ft.) 1 bath, 2 BR cabin that sleeps 4 with 1 full & 2 twin beds. Cozy with a stone fireplace and all pine interior. Outside ramp leads to a small deck and into an enclosed porch. Rental includes 1 free dock space.

**Cabin #5 – Hummingbird:** (608 sq. ft.) 1 bath, 3 BR cabin that sleeps 7 with 2 double beds, 2 twins, and single sleeper in LR. Stone fireplace & refinished hardwood floors in LR. Our 2nd largest cabin has a large wrap-around deck that gives the full 4-mile view of the lake! Rental includes 1 free dock space.

**Cabin #6 – Moose:** (616 sq. ft.) 1 bath, 2 BR cabin that sleeps 6 with 1 full bed, 2 twins, and a queen sleeper in LR. Large open concept w/fireplace. All knotty pine interior. Accessible ramp. Large deck gives the full 4-mile view of the lake. Our largest cabin! Rental includes 1 free dock space.

**RENTAL UNIT RATES**

Rental Unit	# of People Included in Rate	Max. Occ.	Rate Per Week	Rate Per Day
Family House	6	10	\$1100	\$230
#1	2	6	\$650	\$125
#2	2	8	\$665	\$130
#3	2	6	\$665	\$130
#4	2	4	\$665	\$130
#5	2	7	\$665	\$130
#6	2	6	\$665	\$130

**Reservations:** Must be made on either a weekly basis (Saturday to Saturday) or a partial-week basis (a 2-day minimum stay within a full week).

**Extra Person Rates:** \$75 per person per week  
\$20 per person per day

**Check-In Time:** 3 PM or later on arrival day

**Check-Out Time:** Before 9 AM on departure day